

PP

(replaces datasheets 1010/19 and 23)

General description

The balanced PP proportioner induces foam concentrate into the water feed line. Foam proportioning accuracy is maintained during fluctuations in water flow and pressure.

Application description - PP

This type of proportioner is used in foam pump systems. The PP series is designed for monitor and deluge systems.

Product features

- Maintenance free design
- High quality, high reliability
- Manufactured using corrosion resistant design and materials
- Factory set to deliver accurate foam proportioning over full performance range, up to 3%
- Wafer type water connection
- Flanged or screw threaded BSP foam connection

Connections

- Water: wafer mounted between flanges, see table
- Foam: flanged to fit DIN or ANSI or threaded BSP, see table

Listings and approvals

- Det Norske Veritas (DNV)
- Tested according to and complying with EN 13565-1

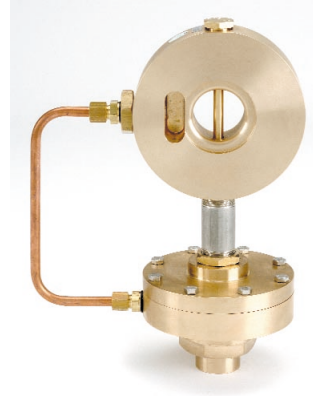

PP-80

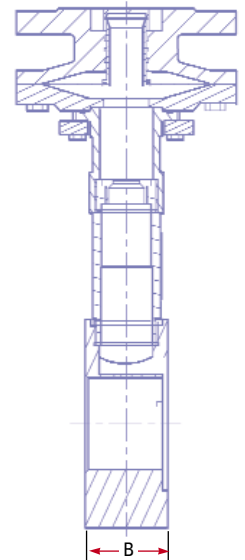
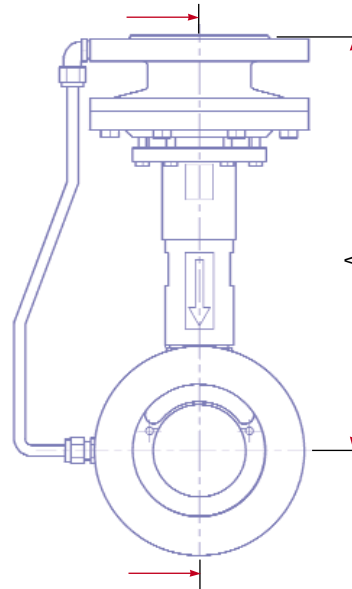

Performance Data PP Proportioners

| Type | Connection | | Capacity | | | | Proportioner k-factor | Weight | | Max. working Pressure | | Material |
|--------|------------|-----------|------------|-------|-------------|--------|-----------------------|--------|-----|-----------------------|-----|-------------------|
| | Foam | Water | Min. l/min | USGPM | Max.* l/min | USGPM | | kg | lbs | bar | psi | |
| PP-50 | 3/4" BSP | 50 / 2" | 125 | 33 | 800 | 211 | 300 | 6 | 13 | 16 | 235 | Bronze (Cu88Sn12) |
| PP-80 | 3/4" BSP | 80 / 3" | 300 | 79 | 2,000 | 528 | 1,010 | 10 | 22 | 16 | 235 | Bronze (Cu88Sn12) |
| PP-100 | 50 / 2" | 100 / 4" | 770 | 203 | 6,100 | 1,612 | 4,040 | 18 | 40 | 16 | 235 | Bronze (Cu88Sn12) |
| PP-150 | 50 / 2" | 150 / 6" | 1,500 | 396 | 18,000 | 4,756 | 7,990 | 21 | 46 | 16 | 235 | Bronze (Cu88Sn12) |
| PP-200 | 80 / 3" | 200 / 8" | 2,875 | 760 | 36,500 | 9,643 | 17,255 | 43 | 95 | 16 | 235 | Bronze (Cu88Sn12) |
| PP-250 | 80 / 3" | 250 / 10" | 5,100 | 1,347 | 37,850 | 10,000 | 27,060 | 53 | 117 | 16 | 235 | Bronze (Cu88Sn12) |

*At proportioner system pressure drop 1.5 bar Ql/min. = \sqrt{P} bar = k-factor
1 bar = 0,1 MPa = 14,5 psi

Dimensions PP

| Type | A mm | B mm |
|----------|------|------|
| PP-50/20 | 200 | 37 |
| PP-80/20 | 200 | 37 |
| PP-100 | 312 | 62 |
| PP-150 | 333 | 62 |
| PP-200 | 411 | 82 |
| PP-250 | 439 | 82 |



www.skum.com

DELTA FIRE AUSTRALASIA Pty Ltd

PO Box 2149, Mansfield 4122 Australia
Unit 4, 44 Devlan Street, Mansfield, Qld 4122
Ph: +61 7 3349 7817
Fax: +61 7 3219 4182
Email: sales@deltafire.com.au
Web: www.deltafire.com.au

tyco / Fire Suppression & Building Products

Technical changes reserved without notice Copyright © 2007 Tyco Safety Products

Balanced Pressure Proportioner - Mk2

PP

(replaces datasheets 1010/19, 23 and 40)

Operation

The proportioner will operate automatically when the flows and pressure are within the flow range. The foam pressure must be at least one bar higher than the water pressure through the proportioner. Operates all valves in the system smoothly.

Fitting

A minimum of five diameters (D) of straight pipe is required in the water line before entering the proportioner and three diameters (D) after the proportioner.

Order information - please specify:

1. Size
2. Connection: DIN or ANSI
3. Foam concentrate mixing rate (%)



PP-150

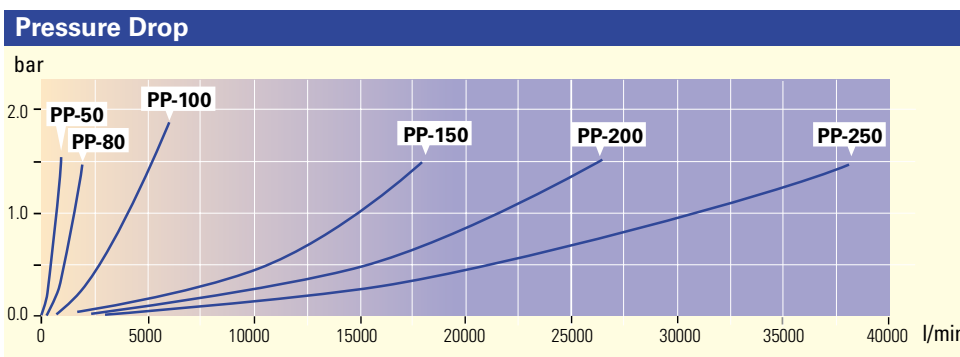
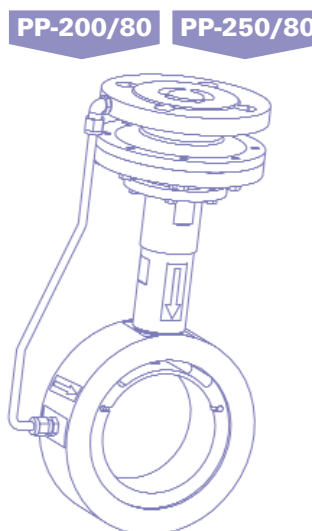

www.skum.com

DELTA FIRE AUSTRALASIA Pty Ltd

PO Box 2149, Mansfield 4122 Australia
Unit 4, 44 Devlan Street, Mansfield, Qld 4122
Ph: +61 7 3349 7817
Fax: +61 7 3219 4182
Email: sales@deltafire.com.au
Web: www.deltafire.com.au

tyco Fire Suppression & Building Products

Technical changes reserved without notice Copyright © 2007 Tyco Safety Products